





VITALITAET MEDTECH CO., LTD.
5F Building 2, No.21 Hongxiang Rd., Dongfeng Industrial Estate, Wenzhou 325006, China

Direct Ophthalmoscope

INSTRUCTION MANUAL

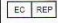
An instruction of ophthalmoscope for ophthalmologist. It is an internally powered device. Please read through this brochure before use, and keep it handy for future reference.

Symbols:

	Manufacturer
	Authorized Representative in the European community
	Symbol for the marking of electrical and electronics devices according to Directive 2002/96/EC. The device, accessories and the packaging have to be disposed of waste correctly at the end of the usage. Please follow Local Ordinances or Regulations for disposal.
	Type B Applied Part
	Attention, consult accompanying documents

SAFETY INFORMATION

To assure the correct use of the product, basic safety measures should always be followed including the warnings and cautions listed in this instruction manual.

Warnings & Cautions:

- Do not use the device where it may be exposed to flammable gas.
- Protect this device from water, moisture, impact, dropping, direct sunlight, heat and fire.
- Do not touch the lens directly by hand or something hard.
- Please use the bulb type specified in this instruction brochure.
- Keep the device out of the reach of unsupervised infants and children.
- Do not disassemble or attempt to repair the device or components.

GENERAL

Description:

Direct ophthalmoscope, a classic medical device for ophthalmology, adopts a professional lens system. It makes doctors conveniently get a clear visual field and examine the interior structures of eyes, such as dioptic media etc..

Technical Specifications:

- XHL Xenon Halogen Bulb and LED Bulb for option.
- V-BP101 (LED Bulb) or V-BP102 (XHL Bulb) used.



- 5 different apertures.



- Range of lenses: -20 D to +20 D

+	1	2	3	4	6	8	10	15	20
-	1	2	3	4	6	8	10	15	20

HOW TO USE THIS DEVICE

- Turn on (or off) the device by pushing downwards (or upwards) as fig.1;
- Scroll the diopter wheel in two directions as fig.2 to select a suitable diopter, which helps to get a clearer observation vision for user;
- Scroll the diaphragm wheel as fig.3 for getting a needed aperture;
- Diagnose by aiming the light to the patient's eye as fig.4.

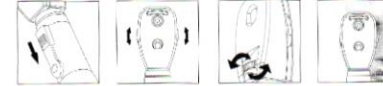

Attention:
It is an intermittent operated device, 1 minute ON, 5 minutes OFF.

MAINTENANCE

Changing Spare Parts:



1. Changing the bulb (fig.5)

- Turn off the power and unscrew the head from the handle of device;
- Pull the old bulb downwards, and replace with new one;
- Screw the head back on to the handle.

Attention:

- Please use the specialized bulb (Model: V-BP101/ V-BP102).
- After the bulb burns out, the temperature will remain high for approximately 5 minutes. Please wait for a moment to avoid injury.

2. Changing the batteries (fig.6)

- Unscrew the bottom cover from the handle;
- Remove the old AA batteries, and replace with new ones. Ensure the anode of the batteries points to the head of the device;
- Screw on the bottom cover of the handle.

Attention:

- AA alkaline batteries are recommended.
- Replace all batteries simultaneously and do not use alkali manganese batteries with lithium as bulb life will be reduced.
- Do not leave worn batteries in the handle.
- Please take out batteries from the device if not in use for a prolonged period.
- Batteries should be disposed of in accordance with local regulations.

Cleaning and Disinfection:

Clean the surface of device with 75% alcohol solution at least once a week, avoiding the lenses in the head. And corrosive or polishing detergent is prohibited.

Attention:

Do not soak, autoclave or let water dip into the device!

PERIODIC SAFETY CHECKS

Preventive inspection and maintenance to be performed including the frequency of such maintenance. The following safety check should be performed at least every 12 months by a qualified person who has adequate training, knowledge, and practical experience to perform these tests.

- Inspect the equipment and accessories for mechanical and functional damage.
- Inspect the safety relevant labels for legibility
- Verify that the device functions properly as described in the instructions for use.

SPECIFICATIONS

illumination	Direct Illumination	
Luminance	18.5 Lumen	
Bulb	Specified Model: V-BP101, V-BP102	
Battery	2 AA alkaline batteries	
Operation	Temperature	10°C ~ 35°C
	Humidity	30% ~ 75%
	Air pressure	700 hPa ~ 1060 hPa
Storage & Transport	Temperature	-20°C ~ 70°C
	Humidity	10% ~ 90% (without condensation)
	Air pressure	500 hPa ~ 1060 hPa
Standards	MDD 93/42/EEC	
	IEC 60601-1:2012, IEC 60601-1-2:2007	

ELECTRICAL CLASSIFICATION

Equipment Classification with respect to protection from electric shock: Internally powered equipment.
Degree of protection from electric shock: TYPE B.
Equipment not suitable for use in the presence of flammable mixture: Yes.
Mode of operation: intermittent operation.



Vitalitaet Medtech Co., Ltd.
5F Building 2, No.21 Hongxiang Rd., Dongfeng Industrial Estate, Wenzhou 325006, China

MedNet GmbH

Borkstrasse 10, 48163 Münster, Germany.

The manufacturer reserves the right to make technical changes without notice in the interest of progress. Prior notices will not be given in case of any amendments within this manual.

